

THE CONGRESS OF THE HAWAIIAN PEOPLE & FOR THE MAIANA HAWAIIAN CIVIC CLUB, AND THE COUNCIL OF HAWAIIAN ORGANIZATIONS: THE ALIHA ASSOCIATION.

THE FRIENDS OF KAMEHAMEHA, THE HAWAIIANS THE NATIVE HAWAIIAN LEGAL CORPORATION, HUI MALAMA AINA O KO'OLAUA, OHANA KUALI'I, THE KAMEHAMEHA ALUMNI ASSOCIATION.

KAILUA BUSINESS & PROFESSIONAL WOMEN WINDWARD COALITION OF CHURCHES SOCIAL CONCERNS COMMITTEE: CHRIST CHURCH UNITING, KAILUA UNITED METHODIST CHURCH, ST. JOHN'S LUTHERAN CHURCH, ST. CHRISTOPHER'S EPISCOPAL CHURCH,

WINDWARD UNITED CHURCH OF CHRIST, KEOLUANA UNITED METHODIST CHURCH, EMMAUEL EPISCOPAL CHURCH,

HAWAII COUNCIL OF MARINE SCIENCE TEACHERS WINDWARD ARTISTS GUILD KOKOKAHI YMCA WINDWARD NEWCOMERS CLUB

HAWAII'S THOUSAND FRIENDS HALAU MOHALA 'ILIMA HISTORIC HAWAII FOUNDATION QUEEN EMMA HAWAIIAN CIVIC CLUB

UNITED METHODIST DISTRICT CHURCH: UNITED METHODIST DIST. DIV. OF CHURCH & SOCIETY, UNITED METHODIST DIST. COUNCIL ON MINISTRIES, HAWAII EPISCOPAL DIOCESAN COMM. ON THE HAWAIIAN MINISTRY

LOW THE ONLY HERBARIUM OF HAWAII... BENEFICIENT TO GARDENERS OF HAWAII... A SOURCE OF FISH AND TARD IS BEST... ALUMANA STANDING SENTINEL FOR KAWAI NUI AND ALL OF KO'OLAUA...



DESIGNATED HISTORIC SITES

- #359 - Pohukini Heiau. Large court with enclosing walls; platform against west wall; paving disturbed. This site is on the National Register of Historic Places. It was removed from the Hawaii Register of Historic Places in 1980.
- #360 - Holomakani Heiau. Destroyed in the 1800's; land used for agriculture.
- #369 - Pamao. ("Paris of Polynesia") Famous government house built by Kakuhihewa; together with Uloua, Pamao was the training center for youth.
- #370 - Kawai Nui Fishpond. (450 acres). Creation site, important food source, hub of community, sacred waters. Guardians- Houmea, Olomano, Hauwahine.

- #371 - Uloua Heiau. Large stone terrace, spring. This site is on the National Register of Historic Places and the Hawaii Register of Historic Places.
- #372 - Kukupiliua Heiau. Destroyed? Stones removed in building the road. Kawai'oo Spring part of heiau. Also called Heinau Heiau.
- #373 - Halaualolo Heiau. Two terraces.
- #374 - Kukaopaki Heiau. Several terraces, one grave. Location not clear.
- #375 - House sites, graves. This site was on the Hawaii Register of Historic Places, but was removed from the register in 1980.

- #376 - Pohaku Puaa. A stone with a hole.
- #377 - Kaelepu Fishpond. (200 acres)
- #378 - Alala Heiau. Destroyed.
- #379 - Kanaha Heiau. Only one terrace left.
- #380 - Kelikipulua Heiau. Destroyed.
- #1020 - Puu Maniwa Heiau. Part of Pali Complex #1174.
- #1021 - Habitation site? Destroyed. May have been the site of Holomakani Heiau. Possibly Kapoo taro complex.
- #1023 - Ko'a on Papoala Island. Fishing shrine.
- #1088 - Lo'i. Terrace walls. Kawai Nui area. Incorrectly recorded as destroyed. (Site #7)
- #1089 - Lo'i. Kawai Nui area. Incorrectly recorded as destroyed.
- #1090 - Lo'i. Kaelepu shores.
- #1091 - Lo'i. Kaelepu shores.
- #1092 - Lo'i. Kaelepu shores.
- #1093 - Lo'i. Kaelepu shores.
- #1095 - Ko'a. Makulua Islands, south.
- #1096 - Ko'a. Makulua Islands, north.
- #1097 - Basalt workshop, Makulua Islands.

- #1168 - Terraces. Part of Pali Complex #1174.
- #1174 - Pali Complex. Includes #1020, #1168. This site was on the Hawaii Register of Historic Places, but it was removed from the register in 1980.
- - Burials. Sand burials beneath streets and homes in Kailua's coastal areas. (Locations unavailable, no designation)
- - Kailua Medical Center burial, 1979. (no designation)
- #7 - Cordy's lo'i with buried walls. Also Ewart's wall and terrace.
- #8 - Historic house foundation and trash. Ewart&Tuggle.
- #9 - Historic house foundation and trash. Ewart&Tuggle.
- #4 - Information unavailable!
- #5 - Three historic house foundations. Ewart&Tuggle.
- #6 - Earth mounds in hau grove. Ewart&Tuggle.
- #40 - Bishop Museum excavation site. Buried coastal habitation site. "fishhook" find ca.1200 AD. Athens.
- #30 - Holua. Rock cairns. Destroyed.
- #31 - Stone terrace walls.
- #32 - Six site clusters. Terrace walls, rock mounds, historic house sites.
- #33 - Two site clusters. Stone terrace walls.
- #34 - Terrace wall, rock mounds.
- #35 - Stone walls.
- #36 - Stone terrace wall.
- #37 - Stone walls, terraces.
- #38 - Stone walls.
- #39 - Lo'i. Same as Cordy's #7 and HRP #1088.

CURRENTLY KNOWN ADDITIONAL HISTORIC SITES

- #a - Approximate 200 lineal foot stone wall.
- #b - Heiau sites.
- #c - Terraced taro lo'i.
- #d - Hawaiian site complex.
- #e - Exceptional Tree Complex.
- #f - Kanahaunui Peak. Male procreative symbol.
- #g - Ahiki Peak. Male procreative symbol.
- #h - Pakui Peak. Male procreative symbol.
- #j - Olomano Peak. Male procreative symbol.
- #k - Hawaiian platform structure.
- #l - Chinese settlement site. Rice fields late 1800's.
- #m - Ulumao Mountain: O'ahu husband of Pele, child of Houmea, whose home was at Kawai Nui. Has reported burial caves, petroglyphs, and sacramental pohaku on its slopes.
- #n - Mahinui Mountain. Male procreative symbol.
- #o - Sacramental stone.
- #p - Holomakani Heiau, destroyed.
- #q - Maki'ole Tree. "Tree of life". Represents the beginning of life and production in the area.
- #r - Waiawa. Inland occupation site for royalty. Earliest known slope occupation c. AD 500-600.
- #s - Lepo'olua ("edible mud") of Kawai Nui.
- #t - Plain of Alele. Kakuhihewa 1550-1600.
- #u - Mokapu Peninsula. Creation site. Halekou, Kaluadui, Nuuaia fishponds.
- #v - Waiawa connection to Waimanalo to pa' honu (turtle ponds).
- #w - Rice Mill late 1800's.
- #x - Poi Factory late 1800's.
- #y - Traditional trail link to valley.
- #z - Adz Quarry.

- #aa - Kanaha Heiau.
- #bb - Kukupiliua Heiau.
- #cc - Kaopua family settlement.
- #dd - Kawai'oo family settlement.
- #ee - Kalaopua family settlement. Birthplace of Kuali'i who ruled all islands from Kailua, 1550-1600.
- #ff - Kaahao family settlement.

NOTES: (Jane Wheeler, Archaeologist, Bishop Museum)

- Marsh Basin perimeter is one of the earliest settled areas in the Hawaiian Islands.
- Marsh Chronology:
 - Phase 1: 4000 BP-c. AD650. Salt water bay transition to lagoon.
 - Phase 2: AD 650-1300. Slopes occupied. Dry field agriculture.
 - Phase 3: AD 1300-1860. Taro.
 - Phase 4: Late 1800's-early 1900's. Rice, Chinese stores, mill.
 - Phase 5: Early 1900's. Pastureland.

DIRECTIONAL PLAN No. 5 for THE AD HOC COMMITTEE FOR KAWAI NUI CULTURAL ARCHAEOLOGY SITES "Ho'okole ka pili a Makalei" "In search of Kailua's wealth"

OCTOBER 1982 5 of 7

ROBERT A. HERLINGER, AIA ARCHITECT, PLANNER

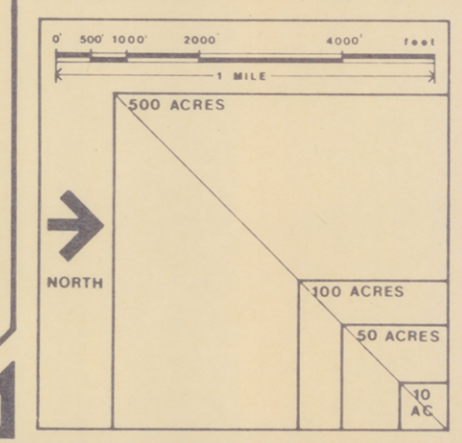
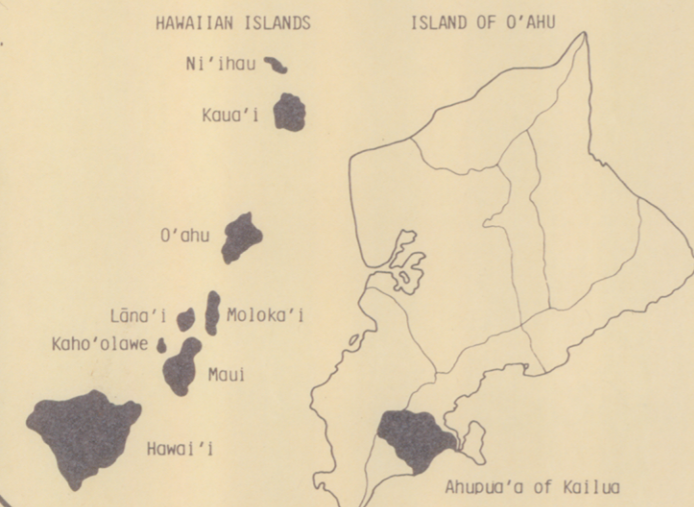

KAWAI NUI HERITAGE PLAN - AHUPUA'A OF KAILUA - O'AHU, HAWAII

HAWAII COUNCIL OF CHURCHES OUTREACH COMM. STATE OF HAWAII DEPT. OF PLANNING & ECONOMIC DEVELOPMENT DIVISION OF CULTURAL RESOURCES HISTORIC SITES DIVISION THE NATIONAL REGISTER OF HISTORIC PLACES